



# CUSTOM LOW VOLTAGE LIGHTING

## Cast In Place Step Light

### SERIES **RV12**

- For any cast in place material needing indirect step lighting
- Step-Light must be cast into place as concrete is being poured
- Conduit raceway should run from end of step to junction box of transformer
- 12 Volt for economical power use
- Choice of two lamp spacings:
  - "EB" 1.2" oc (max length 10ft.)
  - "STD" 2" oc (max length 15ft.)
- Easy to replace lamps (included) for years of service
  - 10,000 hour average lifetime
- Any custom light length made to the nearest 1/4 inch (maximum fixture length is 15 ft)
- If your project requires arcs or corner turns, please consult factory
- Optional conduit bushing exits are available
- Excellent for interior or exterior applications
- Lead wires exit one end and are 18" long unless specified longer

The RV Cast In Place Step Light is an excellent choice for any indirect step lighting applications featuring a poured concrete step. The rugged PVC housing protects the lighting components and renders an attractive and consistent light output. The Cast In Place fixture illuminates steps in residential, institutional, and other commercial settings. This fixture is installed at the time of concrete pouring, so plenty of time should be allotted for manufacture and shipping.

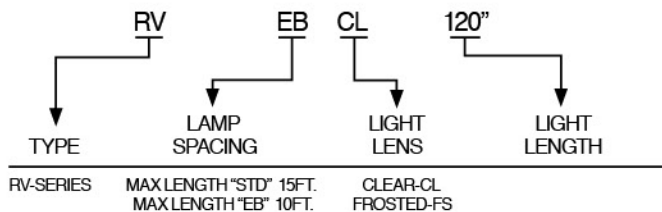
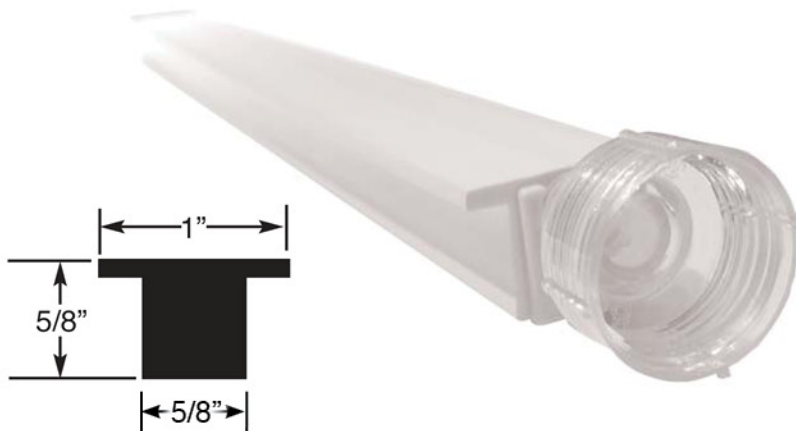

**ORDER/SPECIFY BY CATALOG NUMBERS**





# CUSTOM LOW VOLTAGE LIGHTING

## Cast In Place Step Light

SERIES **RV12**

ETL listed Transformers are NEMA-R3 rated 120/12v and, rated for indoor/outdoor use. The heavy gauge steel enclosure resists weather and corrosion. Special voltages and secondary breaker configurations are available. Please call us for more information.

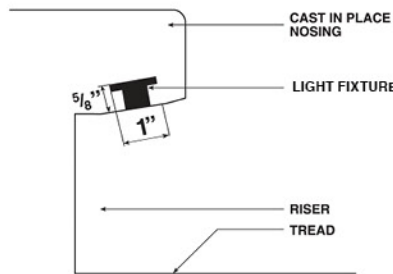
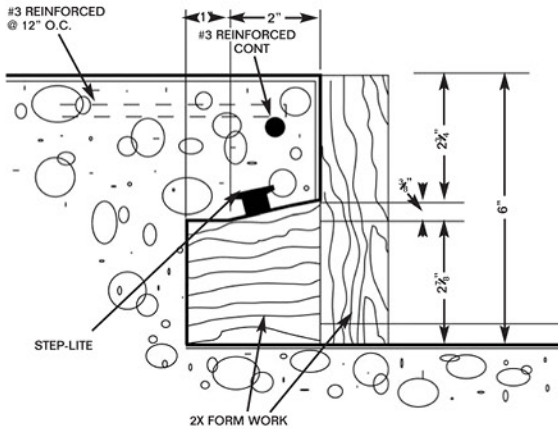

<b>12 VOLT</b>	MODEL	DESCRIPTION	TYPE
	100va	10A breaker (max load 80 watts)	Indoor- Outdoor
	150va	15A breaker (max load 120 watts)	Indoor- Outdoor
	250va	25A breaker (max load 200 watts)	Indoor- Outdoor
	500va	2-25A breakers (max load 400 watts)	Indoor- Outdoor
	750va	3-25A breakers (max load 600 watts)	Indoor- Outdoor
1000va	4-25A breakers (max load 800 watts)	Indoor- Outdoor	

LAMP SPACING	COLOR TEMPERATURE	SPACING (O.C.)	WATTS/FOOT	LUMENS/FOOT
Standard (STD)	2200K	2"	6	22.8
Extra Bright (EB)	2200K	1.2"	10	38

■ The RSL team will be happy to help with establishing power point locations for your project



ROBERTS STEP-LITE SYSTEMS ■ 8100 SW 15th St. ■ Oklahoma City, OK 73128  
 info@robertsstemplite.com ■ www.robertsstemplite.com  
 405.728.4895 ■ 800.654.8268 ■ F: 405.728.4878

