

LED Cast In Place Step Light

SERIES **RV LED**

- For any cast in place material needing indirect step lighting
- Step-Light must be cast into place as concrete is being poured
- For best results, conduit raceway should run from end of step to junction box of driver
- 12v DC for economical power use
 - 12v DC drivers should be ordered separately
 - Drivers are installed remotely with secondary wiring running back to the light locations
 - 50,000 hour average lifetime
- Any custom light length made to the nearest 1/4 inch
- Maximum fixture length is 15 feet
- Lead wires exit one end and are 18" long unless specified longer
- If your project requires arcs or corners, please consult factory
- Optional conduit bushing exits are available

The RV Cast In Place Step Light is an excellent choice for applications featuring a poured concrete step. The rugged PVC housing protects the lighting components and renders an attractive and consistent light output. The Cast In Place fixture illuminates steps in residential, institutional, and other commercial settings. This fixture is installed at the time of concrete pouring, so plenty of time should be allowed for manufacture and shipping.



RV LEAD EXIT OPTIONS:

BACK RIGHT END
BACK LEFT END
END CAP

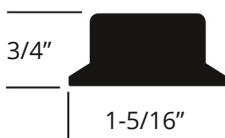

RV Pour in Place LED

RSL

RV - 24 - 2700K - 240/m - 5w/m - 91" - CL
 Fixture Type Voltage Color LED/m Watts/m Length Lens

CL FL
Clear or Frosted



Standard (12vdc) LED options *Great for circuits requiring up to 60w.

| CCT/COLOR | LED/M | LED SPACING | POWER CONSUMPTION | LUMEN OUTPUT +/- 10% | CRI |
|-----------|-------|-------------|-------------------|----------------------|-----|
| 2700K | 60 | .66" | 1.5w/ft - 5w/m | 95/ft - 316/m | 80+ |
| 2700K | 78 | .50" | 2w/ft - 6.4w/m | 123/ft - 410/m | 80+ |
| 3000K | 60 | .66" | 1.5w/ft - 5w/m | 116/ft - 387/m | 80+ |
| 3000K | 78 | .50" | 2w/ft - 6.4w/m | 120/ft - 401/m | 80+ |
| 4000K | 60 | .66" | 1.5w/ft - 5w/m | 128/ft - 428/m | 80+ |

Standard (24vdc) LED options *Great for circuits requiring up to 96w.

| CCT/COLOR | LED/M | LED SPACING | POWER CONSUMPTION | LUMEN OUTPUT +/- 10% | CRI |
|-----------|-------|-------------|-------------------|----------------------|-----|
| 2700K | 240 | .165" | 1.5w/ft - 5w/m | 143/ft - 480/m | 90+ |
| 2700K | 240 | .165" | 3w/ft - 10w/m | 269/ft - 900/m | 90+ |
| 3000K | 240 | .165" | 1.5w/ft - 5w/m | 156/ft - 520/m | 90+ |
| 3000K | 240 | .165" | 3w/ft - 10w/m | 288/ft - 960/m | 90+ |
| 4000K | 240 | .165" | 1.5w/ft - 5w/m | 165/ft - 550/m | 90+ |
| 4000K | 240 | .165" | 3w/ft - 10w/m | 305/ft - 1020/m | 90+ |

SERIES RV LED

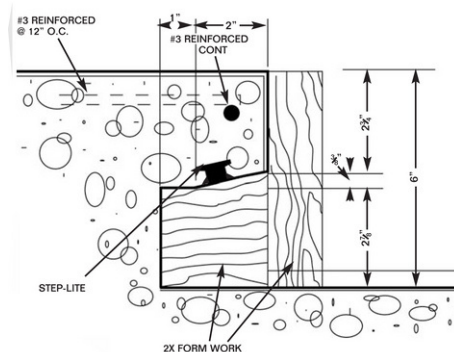
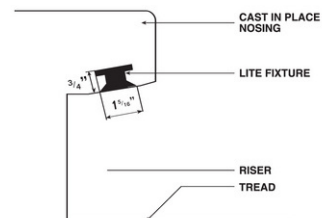

Custom fabricated fixtures are manufactured to the exact dimension required. Each LED fixture is built with standard 18" lead wires from one end.

NOTE: Various fixtures permit the client to specify from which end the lead wires exit. The maximum fixture length for any type is 15 feet (180 inches).

Please consult with an RSL representative for solutions on extra-long lengths.

